

Gas Stove



Gas Grill

In KA-G or KAW-G, When you need it

Can be changed to a gas stove (required additional accessories)

- ◆No gas stove is required in the kitchen, resulting in cost reduction and space saving.
- ◆Cooks can easily switch between griller and stove on the spot as needed (no tools required) or can be used together!

I want to bake an omelet on the breakfast menu → **Stove**
I want to grill steak on the dinner menu → **Grill**
I want to prepare tomorrow's lunch soup → **Stove**

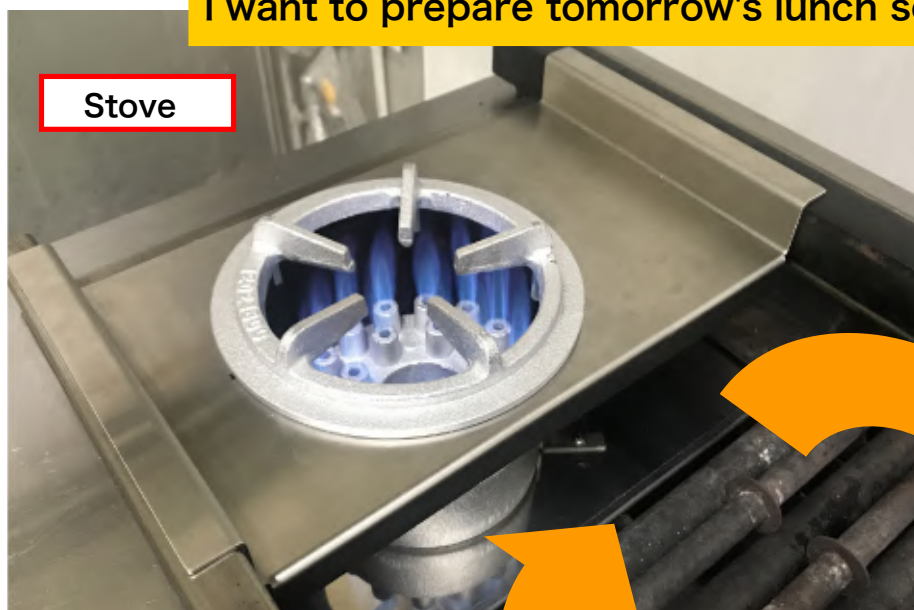

Easy switching

Easy switching

